

Year 5 - Map skills

Subject specific Vocabulary

Compass Rose	A compass rose is a symbol on a map that shows the cardinal directions.
Continent	A large mass of land. There are 7 continents in the world.
Countries	A distinct part of the world with its own government,
Directions	A course along which someone or something moves.
Eastings	The numbers of letters on the x-axis of a grid on a map.
Key	The part on the map which provides a scale and identifies the symbols used on the map.
Map	A representation of an area of land or sea showing physical features, cities, roads, etc.
Northings	The letters of numbers on the y-axis of a grid on a map.
OS symbol	Symbols used to identify key features on a map.
Regions	A area on land that has common features.
Scale drawing	A map where the scale relates to the equivalent distance on earth.
Sketch map	A roughly drawn map that shows only basic details.

Sticky Knowledge

Types of Geography

Human geography–The impact of people on the planet.

Physical geography–the natural world without people;

Environmental geography–human interactions with nature.

Grid references

A grid reference indicates a location in terms of a series of vertical and horizontal grid lines identified by numbers or letters. First you read the eastings and then the northings.

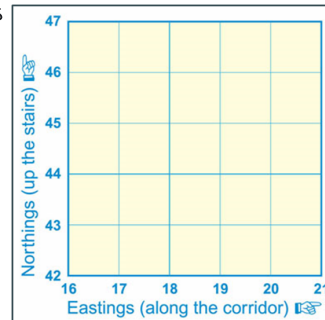

4-figure grid references use 2 digits from the eastings and 2 digits from the northings.

Compass Points

North, Northeast, East, Southeast, South, Southwest, West, Northwest

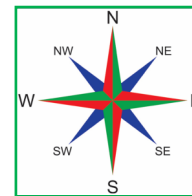

Map symbols

Nature reserve	Road	Parking	Picnic Area	Railway station	Tourist Information	Woods
School	Lake	Church	Camping	Viewpoint	Hospital	

What is geography?

Geography is the study of the Earth's landscapes, peoples, places and environments. It is, quite simply, the study of the world we live in.

What is a scale drawing?

A map scale is the ratio of a distance on Earth compared to the same distance on a map.

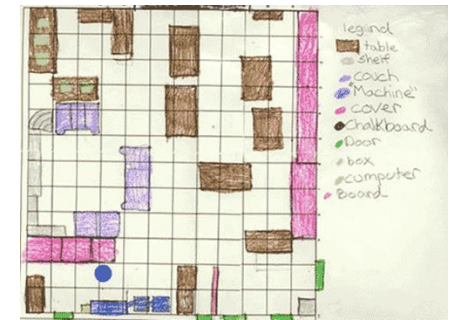

Appropriate maps

Maps are used for many reasons. Some of these reasons include, tracking changes over time, comparing locations, locating a place and plotting a route.

